



Traffic Advisory – For Immediate Release Friday, September 6, 2019

Upgrades to select County roads and culvert begin next week

Township Road 730 from Highway 724 to Range Road 84 south entrance will be temporarily closed to replace a culvert starting on Monday, September 9 and reopening by September 13, weather dependent. A culvert is an underground steel tunnel that carries stream water.

During the closure, traffic is advised to detour using Township Road 730 west of Range Road 84, and Range Road 84.

On Tuesday, September 10, Range Road 94 from Township Road 750 to Township Road 754 will be temporarily closed until late-September, weather dependent, to reshape the shoulder and road, and strengthen the soil of the road.

During the closure, traffic is advised to detour using Township Road 754, Range Road 92 and Township Road 750.

All start and completion dates for road construction and infrastructure rehabilitation projects are weather dependent.

Please see attached for project maps. The red line on each map indicates the location of the road closure and the green lines indicate the detour routes.

The County thanks motorists for their patience and cooperation throughout the construction season.

-30-

Media contact:

Dale Van Volkingburgh
Public Works Director
780-532-9722



TWP 730 road closure

County Of Grande Prairie

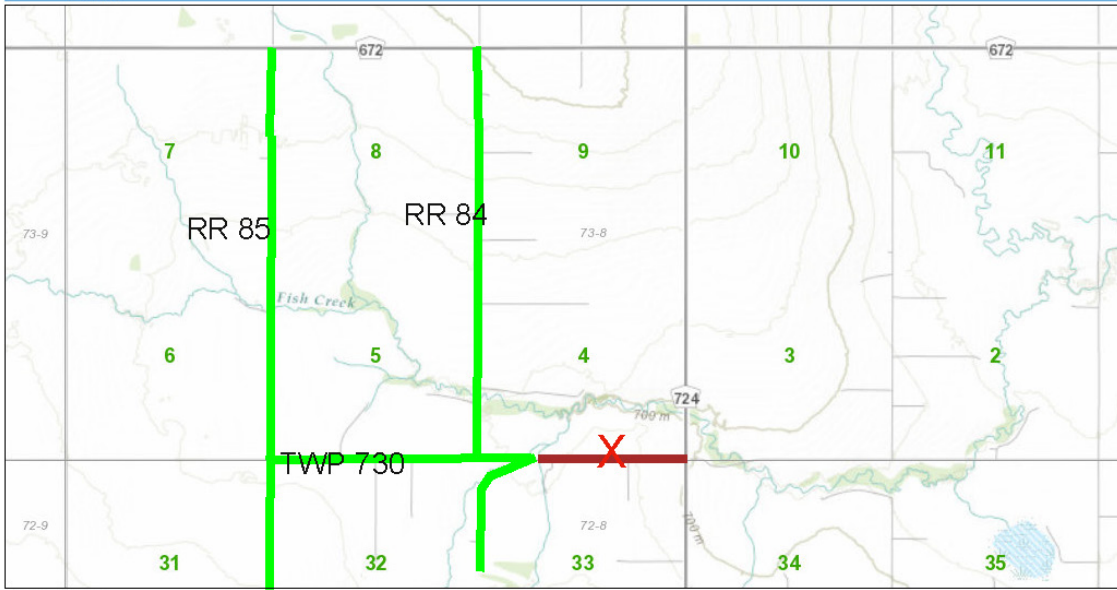

Scale 1:56,964

Green - detour
Red - road closed



The County of Grande Prairie No. 1 makes no representation or warranty regarding the information contained in this document, including, without limitation, whether the said information is accurate or complete. Persons relying on this document do so solely at their own risk, and the County of Grande Prairie No. 1 shall have no liability to such persons for any loss or damage whatsoever. Names may appear different than how they are registered with Alberta Land Titles. This document may not be copied or distributed to any other person without the express written consent of the County of Grande Prairie No. 1.

County of Grande Prairie No. 1 Enbridge - Abn. Map

10001 84 Avenue, Clairmont, AB T8X 5B2
Phone: 780-532-9722 email: info@countygp.ab.ca

NOT RESPONSIBLE FOR ERRORS OR OMISSIONS.



County of GP Web Map
County Of Grande Prairie

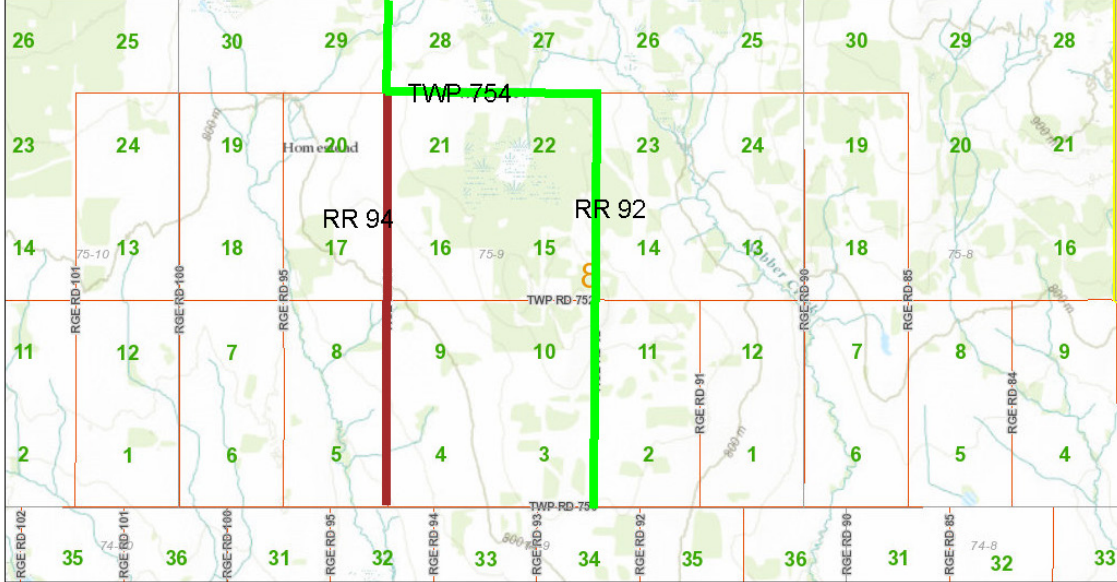

Scale 1:113,927
Red - road closed local traffic only
Green - detour



The County of Grande Prairie No. 1 makes no representation or warranty regarding the information contained in this document, including, without limitation, whether the said information is accurate or complete. Persons using this document do so solely at their own risk, and the County of Grande Prairie No. 1 shall have no liability to such persons for any loss or damage whatsoever. Names may appear different than how they are registered with Alberta Land Titles. This document may not be copied or distributed to any other person without the express written consent of the County of Grande Prairie No. 1.

County of Grande Prairie No. 1 Enterprise Web Map 10001 84 Avenue, Clairmont, AB T8X 5B2 NOT RESPONSIBLE FOR ERRORS OR OMISSIONS.
Phone: 780-532-9722 email: info@countygp.ab.ca